

**NOTES**

1. TO BE BUILT & DELIVERED AS 2 SEPARATE PIECES. CUSTOMER TO ASSEMBLE ON SITE.  
PART 1 - CT CHAMBER ON STAND.  
PART 2 - GRP ENCLOSURE.
2. SHEET 2 SHOWS CT CHAMBER ASSY.

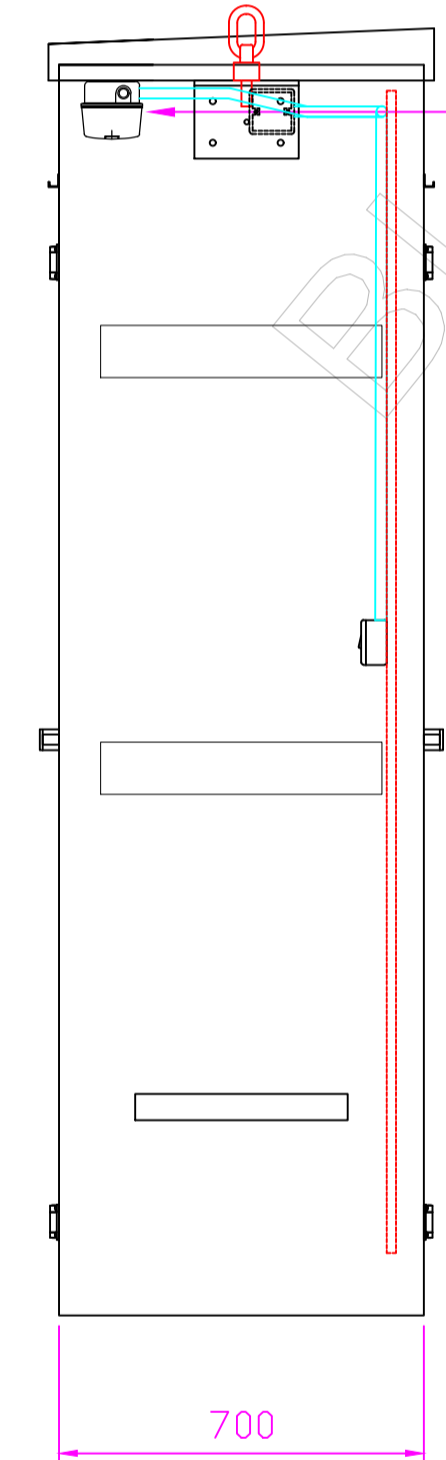

DNO METERING COMPARTMENT

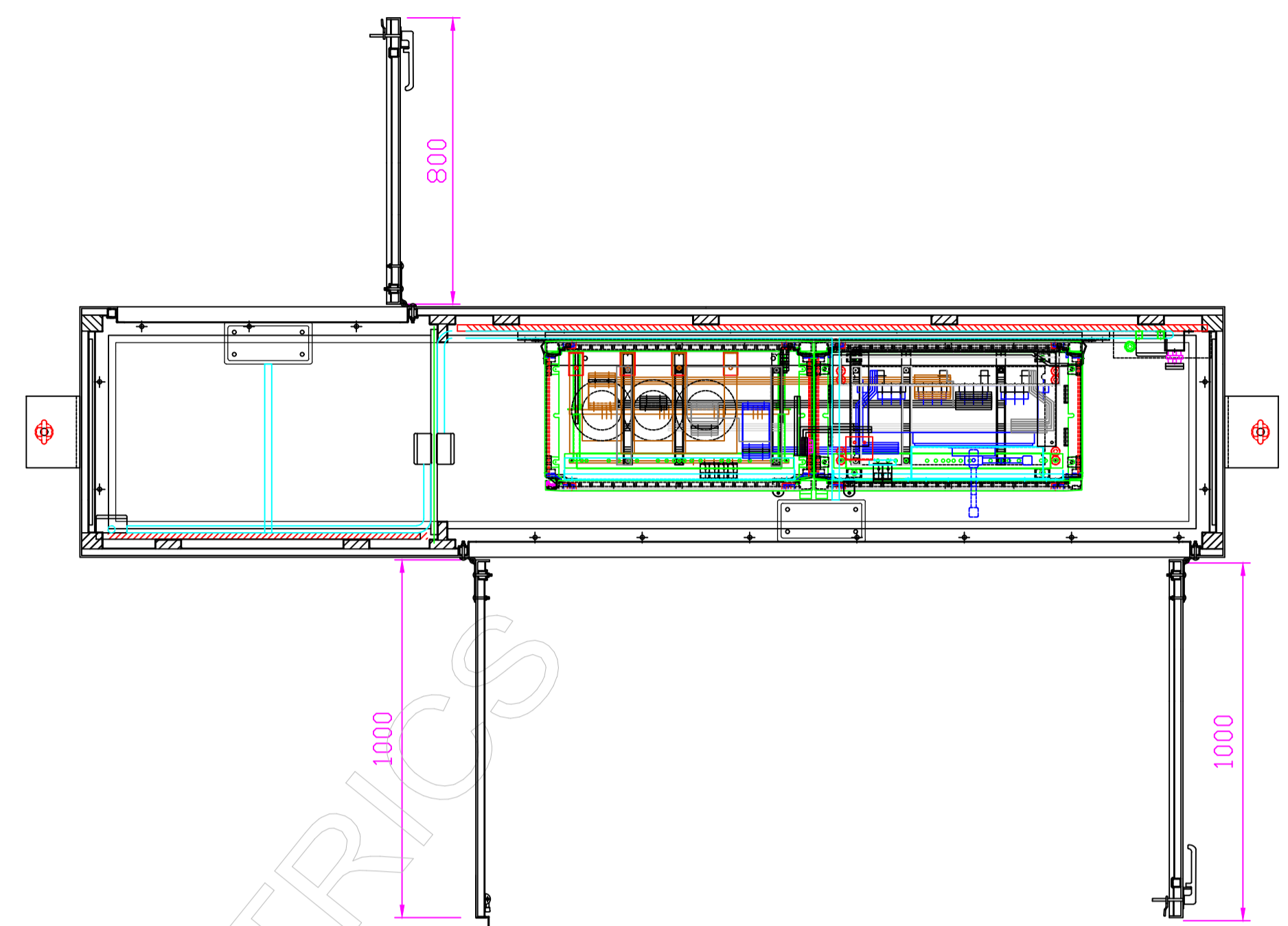
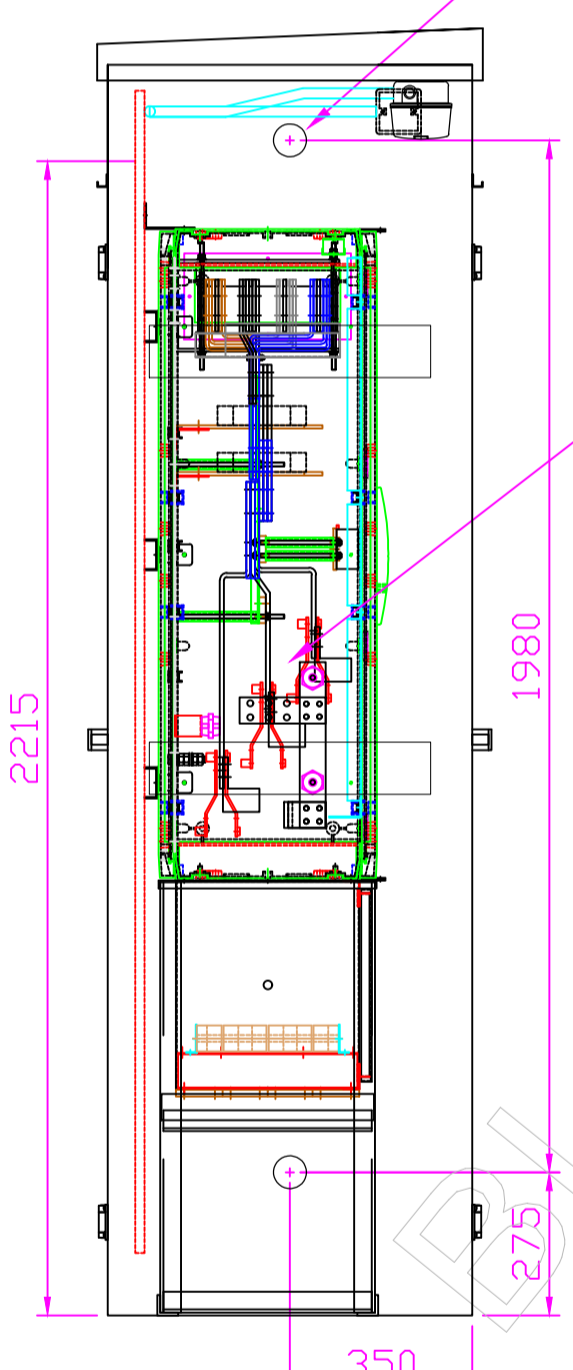

CT CHAMBER COMPARTMENT

2x Ø63mm CABLE HOLES IN DIVIDER PANEL

3x M10 EARTH STUDS

BULKHEAD LIGHT SWITCH (DNO CHAMBER)

SPACE FOR CUSTOMER DNO METERING EQUIP (REAR OPENING DOOR)

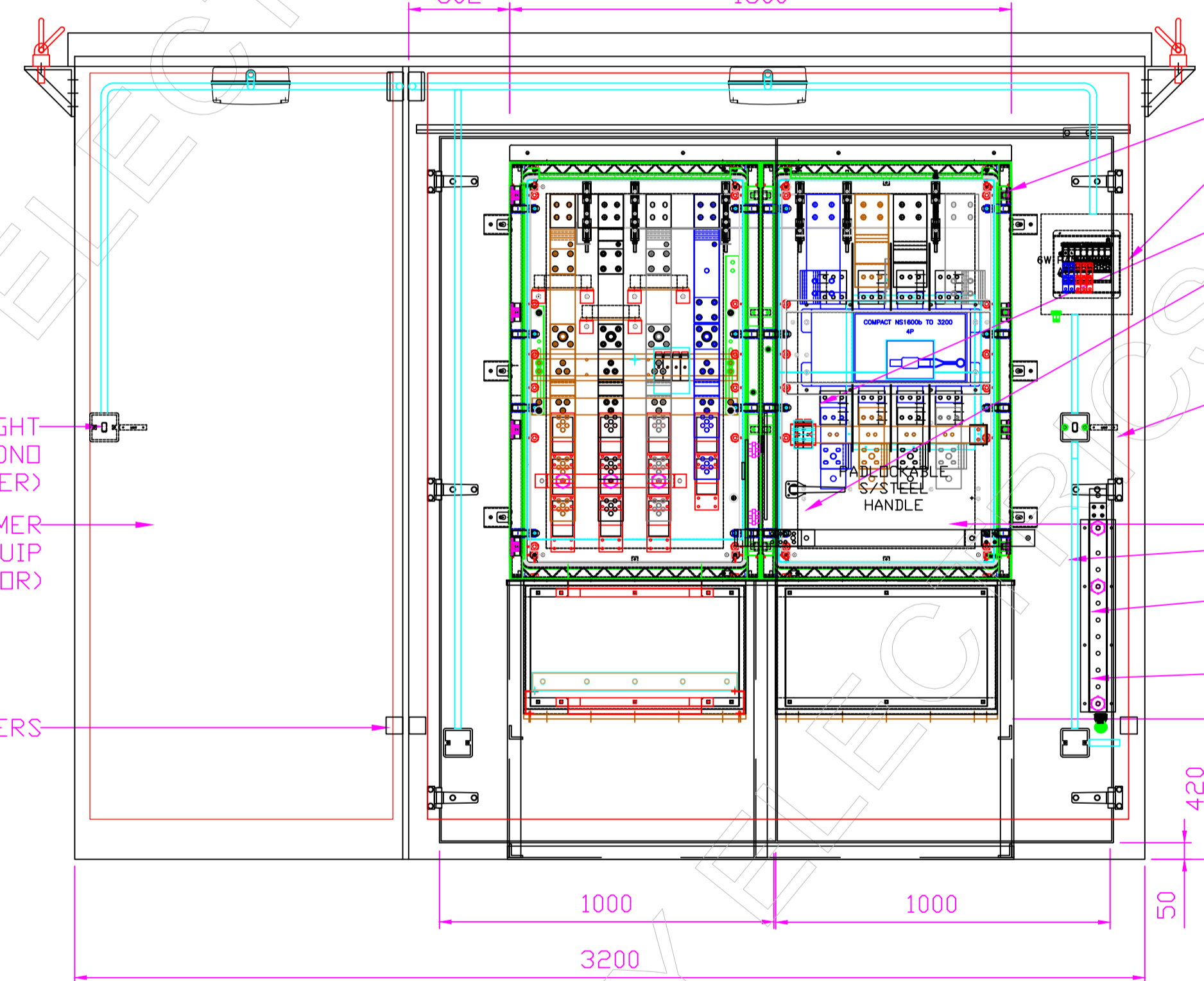

CTC 2000A DIST BOARD 6 WAY

DIST BOARD FUSING 32A

M12 EARTH STUD EARTHS TO BE CONNECTED FRONT & REAR OF BAR

BULKHEAD LIGHT SWITCH (CT CHAMBER)

EARTH BAR SHIELD PVC CONDUIT

INTERNAL CROSS BOND STUDS

6W SOLID EARTH BAR M10 STUDS

BULKHEAD LIGHT FITTED TO ENC. WOODEN BEAM (FRONT SECTION)

HEATERS

CUSTOMER INFORMATION COPY

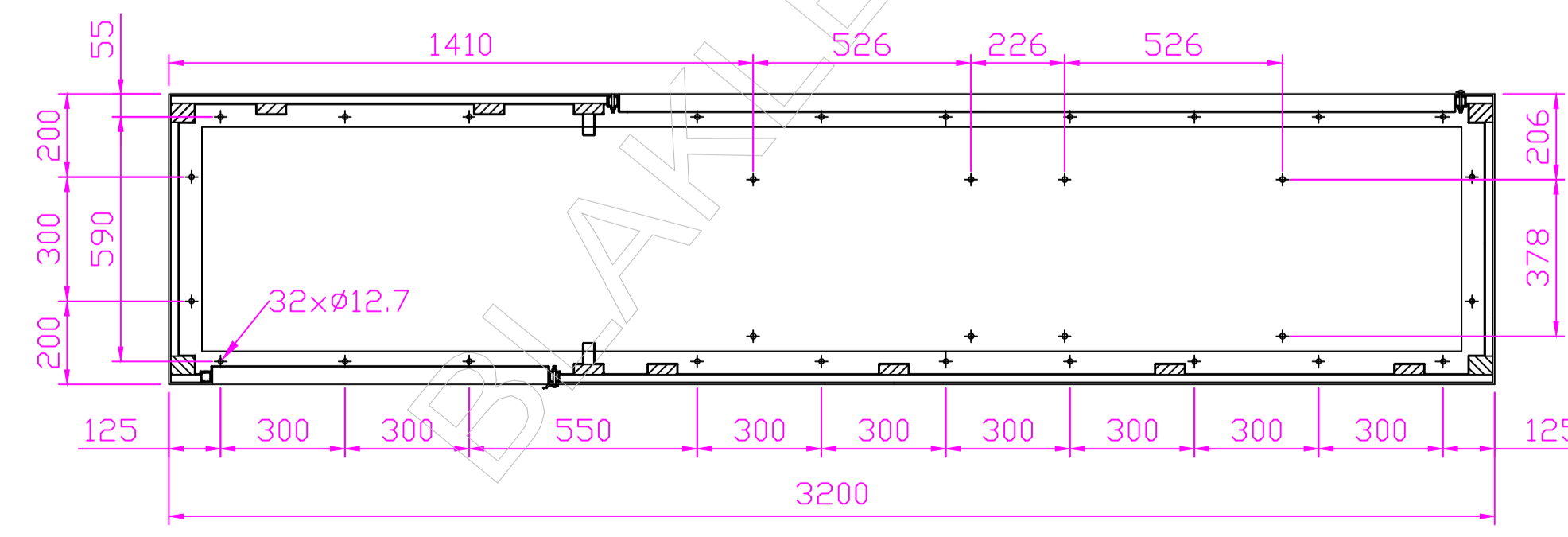

VIEW IN DIRECTION OF ARROW A FIXING DOWN DETAILS

REV: A	B	C													
EDR: 7904	7909	7931													
UNLESS OTHERWISE STATED:- ALL DIMENSIONS IN MM. TOLERANCES TO H30052. FIXING STANDARD TO H30051. WIRING STANDARD TO H20051. WELDING STANDARD TO QAI 061.												MATERIAL		SIZE	
DO NOT SCALE THIS DRAWING. IF IN DOUBT, ASK												REF: A7292815		COPY ISSUED 08 Dec 2020	
DATE: 04.09.20												ORIGINAL SCALE 1:14		BLAKLEY ELECTRICS LIMITED	
TITLE: GEN ASSY EQUIPPED DNO ENC SIEMENS												DRAWING No. A7292815		REVISION C	
CHKD. MG												APPD. [Signature]			

BASED ON SK2738