

SOCKETS AND GLANDS MOUNTED TO THE SIDES TO MINIMISE DEPTH

REMOVABLE LID

INCOMING TERMINALS TO BE 3 POLE  
A 3 PHASE SUPPLY CABLE  
CAN BE CONNECTED IN ORDER TO  
HELP BALANCE PHASES WHEN USING  
MULTIPLE UNITS ON ONE SITE

230:110V RLV 5kVA  
SINGLE PHASE TRANSFORMER

CIRCUIT PROTECTIVE DEVICES LOCATED  
UNDER A STEEL DOLLY COVER

SPACE FOR UP TO 4  
OUTPUTS ON EACH  
SIDE SUITABLE FOR  
A COMBINATION OF;  
32A SOCKETS  
16A SOCKETS  
OR LIGHTING GLANDS

2P MCB  
INCOMING PROTECTION

3 OFF 10A LIGHTING GLANDS  
1 OFF BLANK PLATE

12.0mm HEAVY DUTY  
LIFTING HANDLES

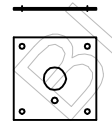
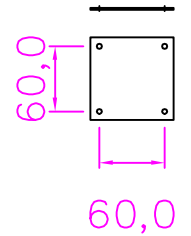

HEAVY DUTY  
WELDED STAND

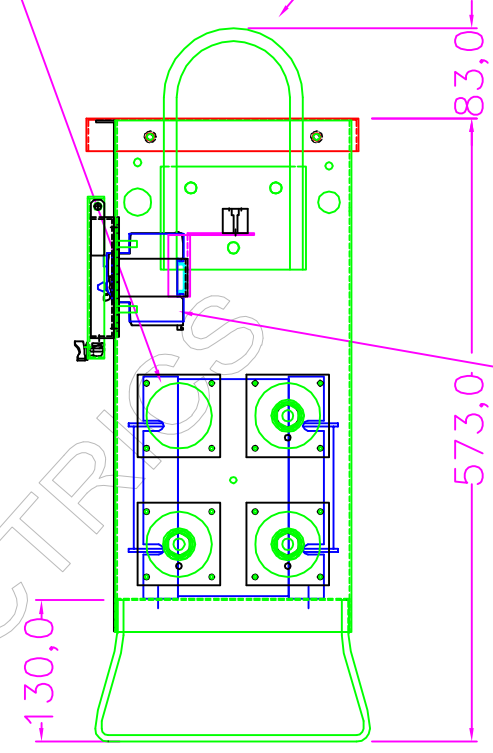
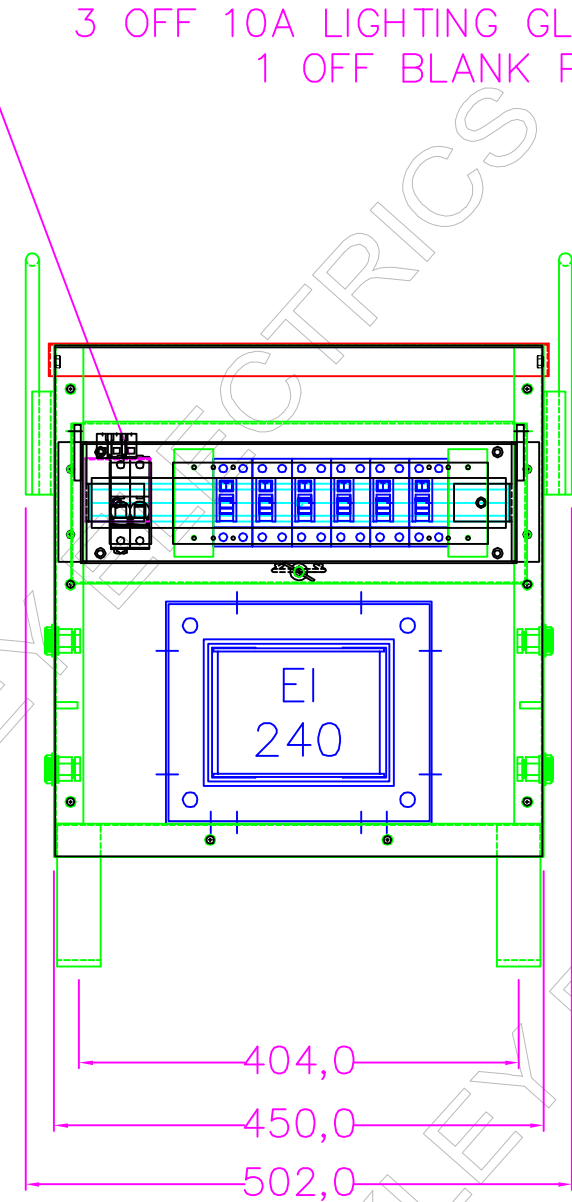
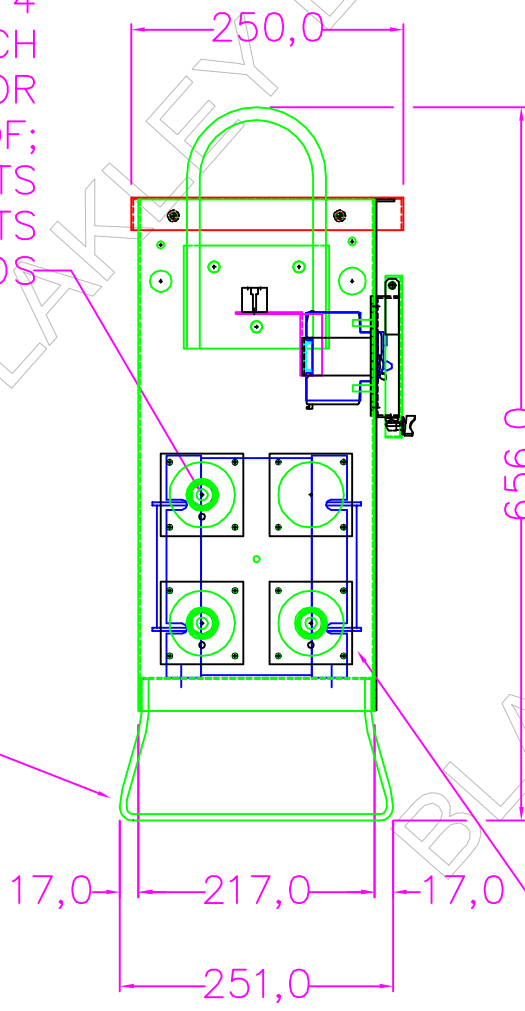

DP OUTPUT MCBs -  
110V 16A SOCKETS  
PROTECTED IN PAIRS,  
LIGHTING CIRCUITS  
PROTECTED INDIVIDUALLY  
AND WITH RCCBs

3 OFF 10A LIGHTING GLANDS  
1 OFF BLANK PLATE

THIS DRAWING IS THE PROPERTY AND COPYRIGHT OF BLAKLEY ELECTRICS AND MUST NOT, WITHOUT THEIR WRITTEN CONSENT, BE PASSED ON, COPIED, OR USED FOR ANY OTHER PURPOSE. THIS COPY IS UNCONTROLLED UNLESS OTHERWISE MARKED.

REV:	A	B	C	D								
EDR:	6875	6891	6992	7043								
UNLESS OTHERWISE STATED:- ALL DIMENSIONS IN MM. TOLERANCES TO H30052 FIXING STANDARD TO H30051 WIRING STANDARD TO H20051 WELDING STANDARD TO QAI 61.										MATERIAL		SIZE
DO NOT SCALE THIS DRAWING. IF IN DOUBT, ASK										REF. S210345		COPY ISSUED
TITLE GENERAL ASSEMBLY TA-SL/P/1/5/RCB06-10										ORIGINAL SCALE 1:5 DATE 06.02.17		BLAKLEY ELECTRICS LIMITED
										DRN. TP		DRAWING No. C28840
										CHKD.		REVISION D
										APPD.		SHEET 1 OF 1